

### CITY OF CRAIG, ALASKA BUILDING PERMIT APPLICATION

**Applicant Information**

Name Perry Cass  
 Mailing Address PO Box 1254  
 Street Address \_\_\_\_\_  
 City, State, Zip Craig, AK 99921  
 Telephone 541-912-3279

**Owner Information (if not also applicant)**

Name Shoon-Seet Inc  
 Mailing Address PO Box 690  
 Street Address 501 Main St  
 City, State, Zip Craig AK 99921  
 Telephone 407-826-3251

**Property Description**

Subdivision Name Shoon-Seet Trailer Park  
 Survey Number: \_\_\_\_\_ Tract Number: \_\_\_\_\_ Lot Number: 730 Block Number: \_\_\_\_\_  
 Army Corps of Engineers Permit Name and/or Number: \_\_\_\_\_

**Building Activity Information (please check one)**

- |   |                                   |   |  |
|---|-----------------------------------|---|--|
| <input type="checkbox"/> Single Family Home   | <input type="checkbox"/> Duplex   | <input type="checkbox"/> Triplex        | <input type="checkbox"/> Fourplex or greater |
| <input type="checkbox"/> Deck   | <input type="checkbox"/> Porch    | <input type="checkbox"/> Retaining Wall | <input type="checkbox"/> Addition            |
| <input type="checkbox"/> Commercial Building  | <input type="checkbox"/> Wannigan | <input type="checkbox"/> Garage         | <input checked="" type="checkbox"/> Shed     |
| <input type="checkbox"/> Mobile Home (Year and Make) _____ <u>1997</u>                          |                                   |   |  |
| <input type="checkbox"/> Travel Trailer (Year and Make) _____ <u>34' BOUNDER Motorhome 1997</u> |                                   |   |  |
| <input type="checkbox"/> Other (Please describe): _____   |                                   |   |  |

Height of Building at Roof Eave: 10' Closest setback to property line: 10'  
 Building Dimensions: 10x16 Area of building footprint: 160 SQ FT.

What use(s) do you propose for the building? Storage

**Site Plan**

Please complete on reverse side or attached sheet a site plan showing all proposed construction.

**Owner's/Applicant's Statement**

I acknowledge that I have read this application and state that the above information is correct. I agree to comply with all codes and ordinances of the City of Craig applicable to building and construction, and all land use regulations as pertaining to this permit. Any violation of land management regulations are the responsibility of the property owner. This permit becomes void upon completion of the approved work, or one year, whichever comes first. Work not documented in this application is not authorized by this building permit. I understand that this permit is revocable if work is not completed consistent with this applicant or if work does not comply with the requirements of the City of Craig Municipal Code. I agree to provide the City of Craig with an as-built survey of the lot in the event one is completed for this project.

Signature of Applicant [Signature] Date 2-1-16  
 Signature of Property Owner (if other than applicant) [Signature] Date 2-1-16

**Special Conditions of Approval.**

The following conditions of approval are made a part of this permit as provided by section 18.06.001B.6 of the Craig Land Development Code:  
 #1. Permit is for shed only.  
 #2. No walls constructed within 10' of any property/space line.

Permission is hereby granted to perform the above work in compliance with any and all conditions listed above and in compliance with the Craig Land Development Code and all other ordinances of the City of Craig and the State of Alaska pertaining to the construction of buildings.

Signature of City Building Official [Signature] Date 2-1-16

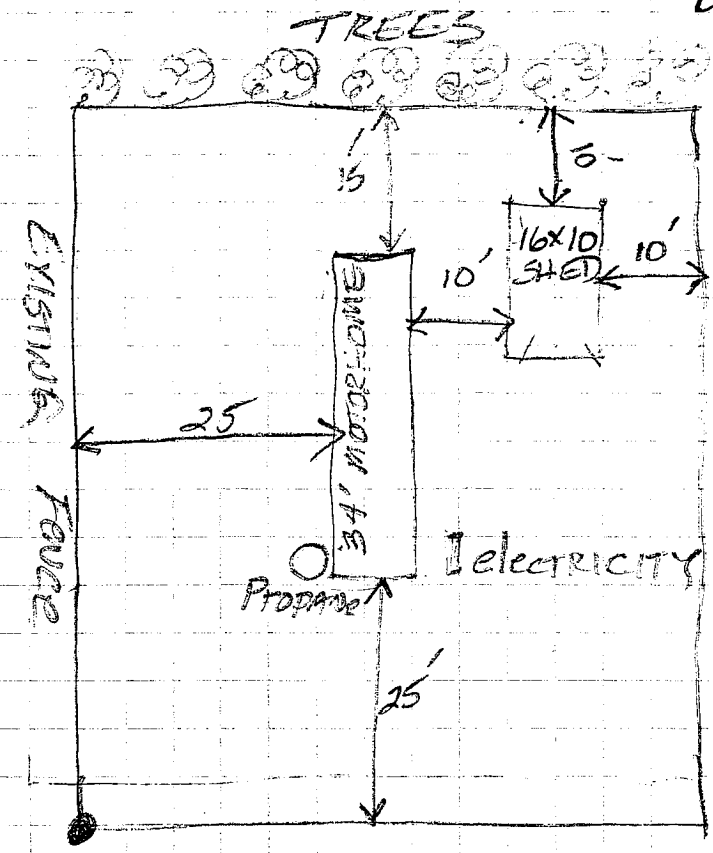

SCALE: GRID = 5'

LOT # 736

Shaam Seet  
Perry & Michelle Cass