

CITY OF CRAIG, ALASKA BUILDING PERMIT APPLICATION

Applicant Information		Owner Information (if not also applicant)	
Name	Arrowhead Transfer, Inc.	Name	
Mailing Address	PO Box 707	Mailing Address	
Street Address	1600 Craig-Klawick Hwy	Street Address	
City, State, Zip	Craig, AK 99921	City, State, Zip	
Telephone	907-826-3419	Telephone	

Property Description

Subdivision Name: CRAB BAY

Survey Number: 2612 Tract Number: S Lot Number: Block Number:

Army Corps of Engineers Permit Name and/or Number: Nationwide Permit 13 v City Approved Access Perm #

Building Activity Information (please check one)

<input type="checkbox"/> Single Family Home	<input type="checkbox"/> Duplex	<input type="checkbox"/> Triplex	<input type="checkbox"/> Fourplex or greater
<input type="checkbox"/> Deck	<input type="checkbox"/> Porch	<input type="checkbox"/> Retaining Wall	<input type="checkbox"/> Addition
<input type="checkbox"/> Commercial Building	<input type="checkbox"/> Wannigan	<input type="checkbox"/> Garage	<input type="checkbox"/> Shed
<input type="checkbox"/> Mobile Home (Year and Make)			
<input type="checkbox"/> Travel Trailer (Year and Make)			
<input checked="" type="checkbox"/> Other (Please describe): Bank Stabilization - Tideland Fill, Park Work			

Height of Building at Roof Eave: _____ Closest setback to property line: _____

Building Dimensions: _____ Area of building footprint: _____

What use(s) do you propose for the building? _____

Site Plan N/A

Please complete on reverse side or attached sheet a site plan showing all proposed construction.

Owner's/Applicant's Statement

I acknowledge that I have read this application and state that the above information is correct. I agree to comply with all codes and ordinances of the City of Craig applicable to building and construction, and all land use regulations as pertaining to this permit. Any violation of land management regulations are the responsibility of the property owner. This permit becomes void upon completion of the approved work, or one year, whichever comes first. Work not documented in this application is not authorized by this building permit. I understand that this permit is revocable if work is not completed consistent with this applicant or if work does not comply with the requirements of the City of Craig Municipal Code.

I agree to provide the City of Craig with an as-built survey of the lot in the event one is completed for this project.

Signature of Applicant: _____ Date: _____

Signature of Property Owner (if other than applicant): *Michael J. Cecchetti* Date: *10/28/15*

Special Conditions of Approval.

The following conditions of approval are made a part of this permit as provided by section 18.06.001B.6 of the Craig Land Development Code:

#1. No change to any building footprint without submission of a site plan

Permission is hereby granted to perform the above work in compliance with any and all conditions listed above and in compliance with the Craig Land Development Code and all other ordinances of the City of Craig and the State of Alaska pertaining to the construction of buildings.

Signature of City Building Official: *Brad M.* Date: *10-29-15*



PO Box 707, Craig, AK 99921
907-826-3419

August 12, 2015

Dept. of the Army
Alaska District, Corps of Engineers
Attn: Danielle Shack, Regulatory Division
PO Box 6898
JBER, AK 99506-0898

Re: POA-2015-312

Dear Ms. Shack,

Thank you for getting our file opened. I am sorry that our original submission did not have all the items you required. Enclosed with this letter, please find additional documents, to add to our project file, as requested:

- Vicinity Maps
- Cross Section view of the project area.
- A statement regarding re-vegetation.

Our bank re-stabilization project will entail digging a ditch just inside the 12.8' high tide line, on our property, to toe-in a layer of clean pit-run armour rock to create a wall. We will then place clean pit-run 6" minus rock behind the wall of armour rock. This will be capped off with clean pit-run D1 Gravel. We estimate needing 150 cubic yards of armour rock, 150 cubic yards of 6" minus, and 50 cubic yards of D1 Gravel. We need approval from you that this project falls under the scope of Nationwide Permit #13.

In order to achieve this project, we need to build a temporary road approximately 10' wide, using clean pit-run 6" minus rock on the outside of the 12.8' high tide line to allow the equipment to reach the project area. This temporary road material will be removed and used to back fill the wall behind the armour rock. This temporary road will be primarily between the mean high water and high tide lines. It will cross beyond the mean high water mark in a small area, approximately 50' long, and only a few feet in width. At the point it crosses, we will then be on City of Craig property, instead of our own property. The City is awaiting your determination on applicability of Nationwide Permit #13 before they will give us access to their property for this temporary road.

Please let us know what more is needed to make this determination. We appreciate your time to assist us and look forward to your reply.

Sincerely,

Sharilyn Zellhuber
Arrowhead Transfer, Inc.

ce of Wales Island

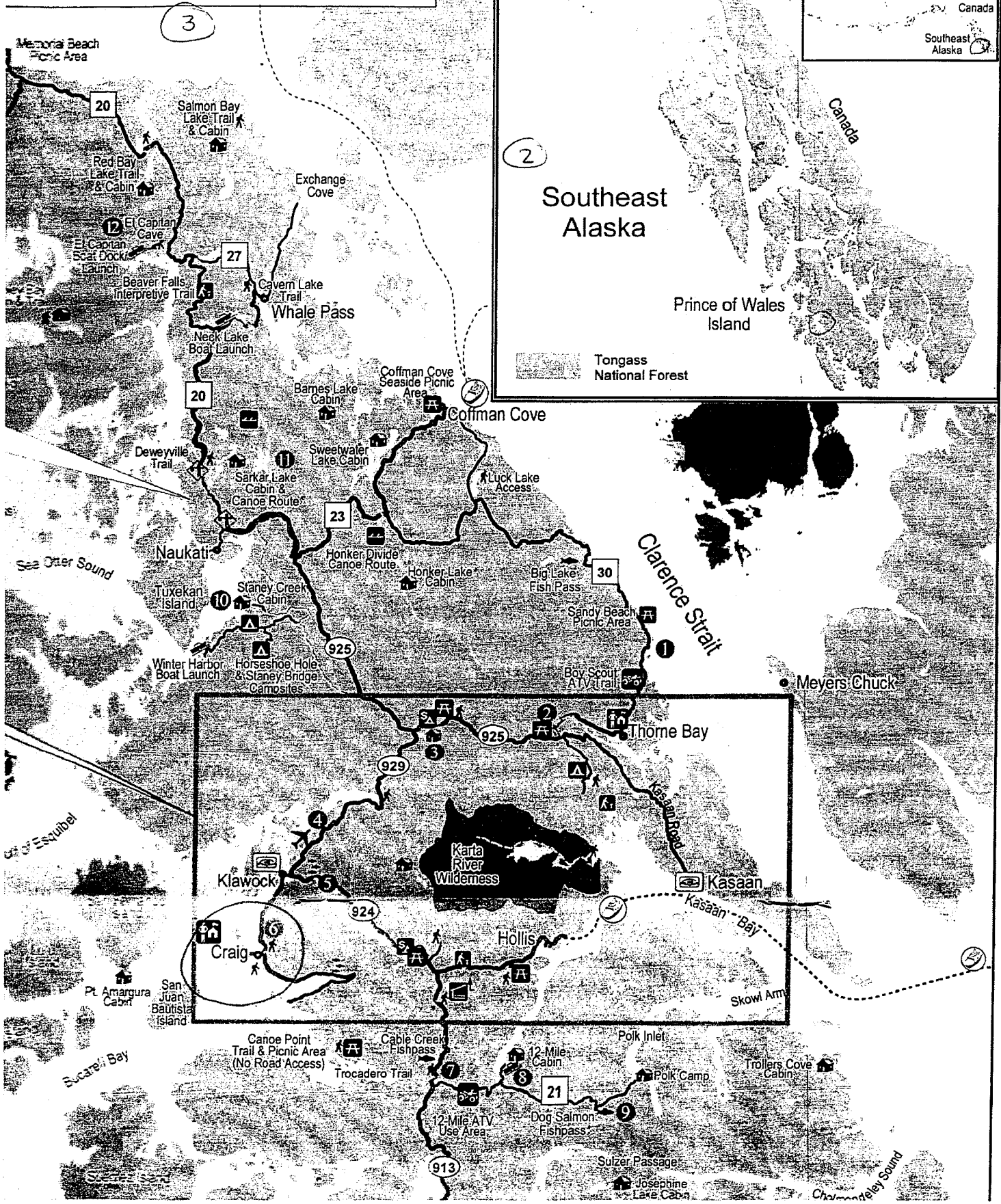

POA - 2015-312
Crab Bay

MAP LEVEL 4



Map of:
Craig, AK

Notes

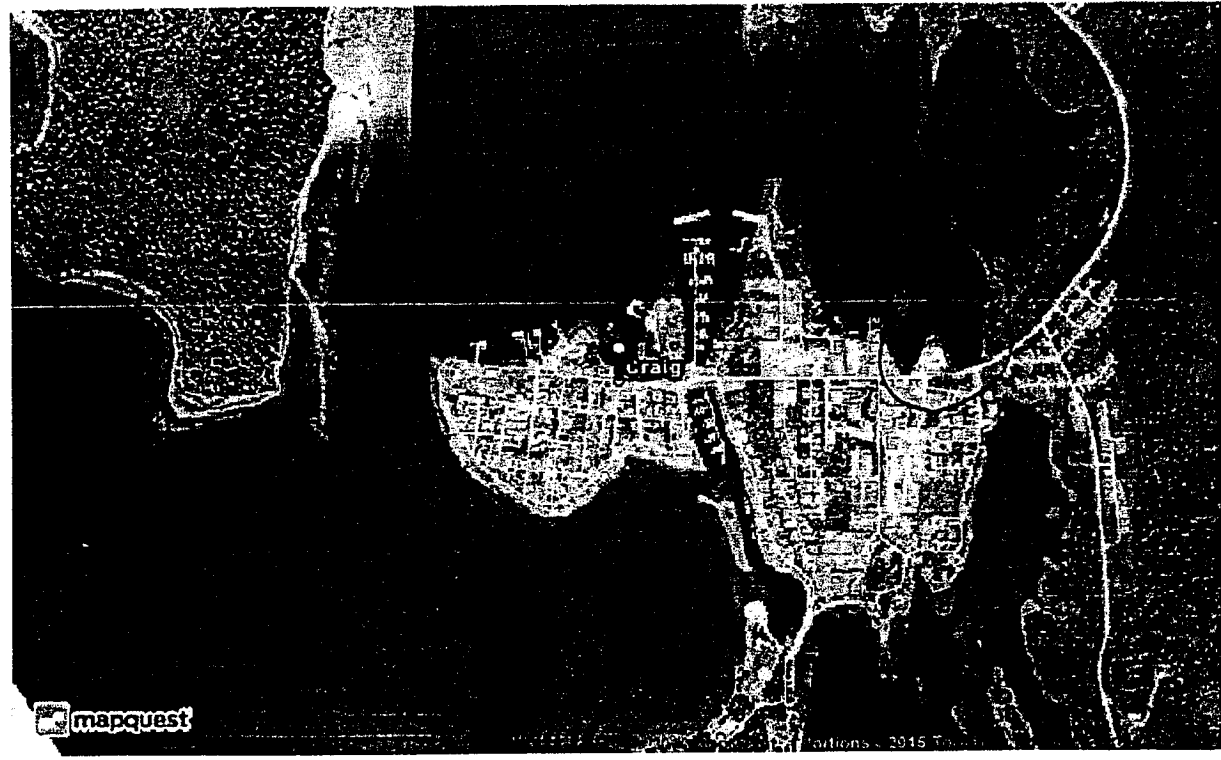
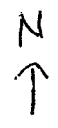

©2015 MapQuest, Inc. Use of directions and maps is subject to the MapQuest Terms of Use. We make no guarantee of the accuracy of their content, road conditions or route usability. You assume all risk of use. [View Terms of Use](#)

PUA - 2015-312

MAP LEVEL 4-enlarged

Crab Bay



mapquest

Map of:
Craig, AK

Notes

N
↑

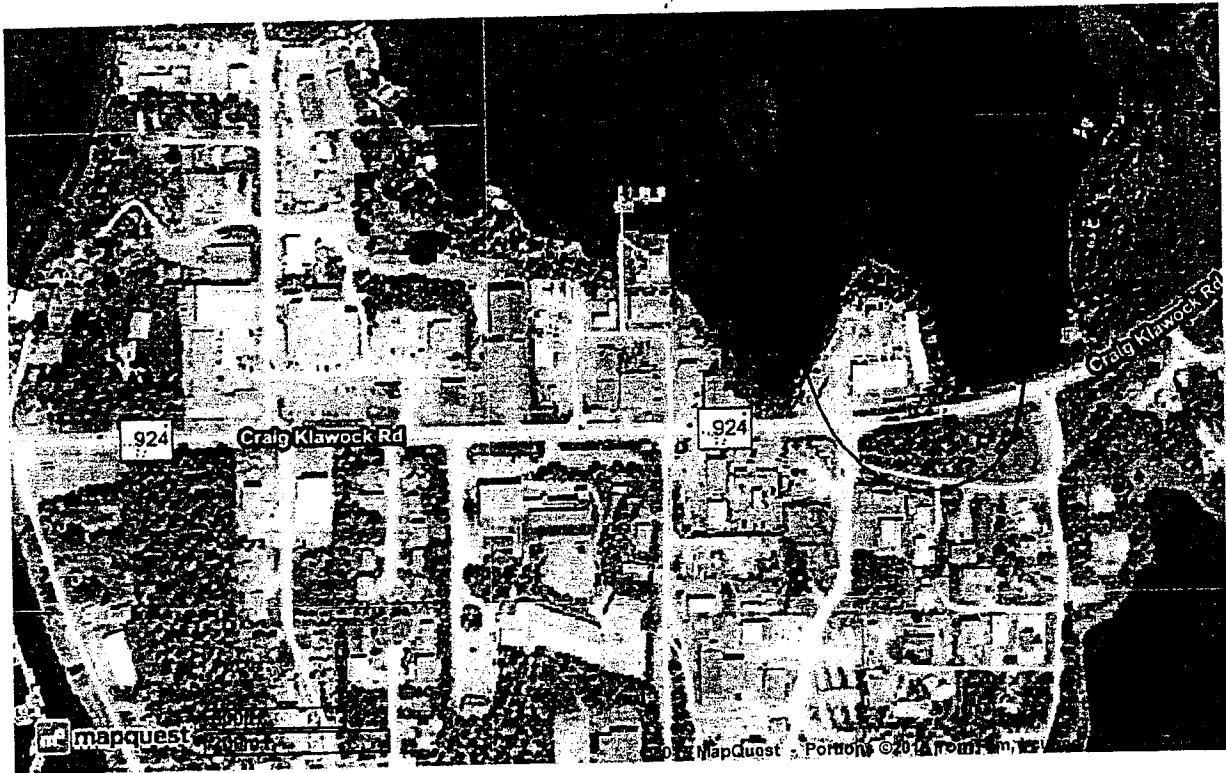

©2015 MapQuest, Inc. Use of directions and maps is subject to the MapQuest Terms of Use. We make no guarantee of the accuracy of their content, road conditions or route usability. You assume all risk of use. [View Terms of Use](#)

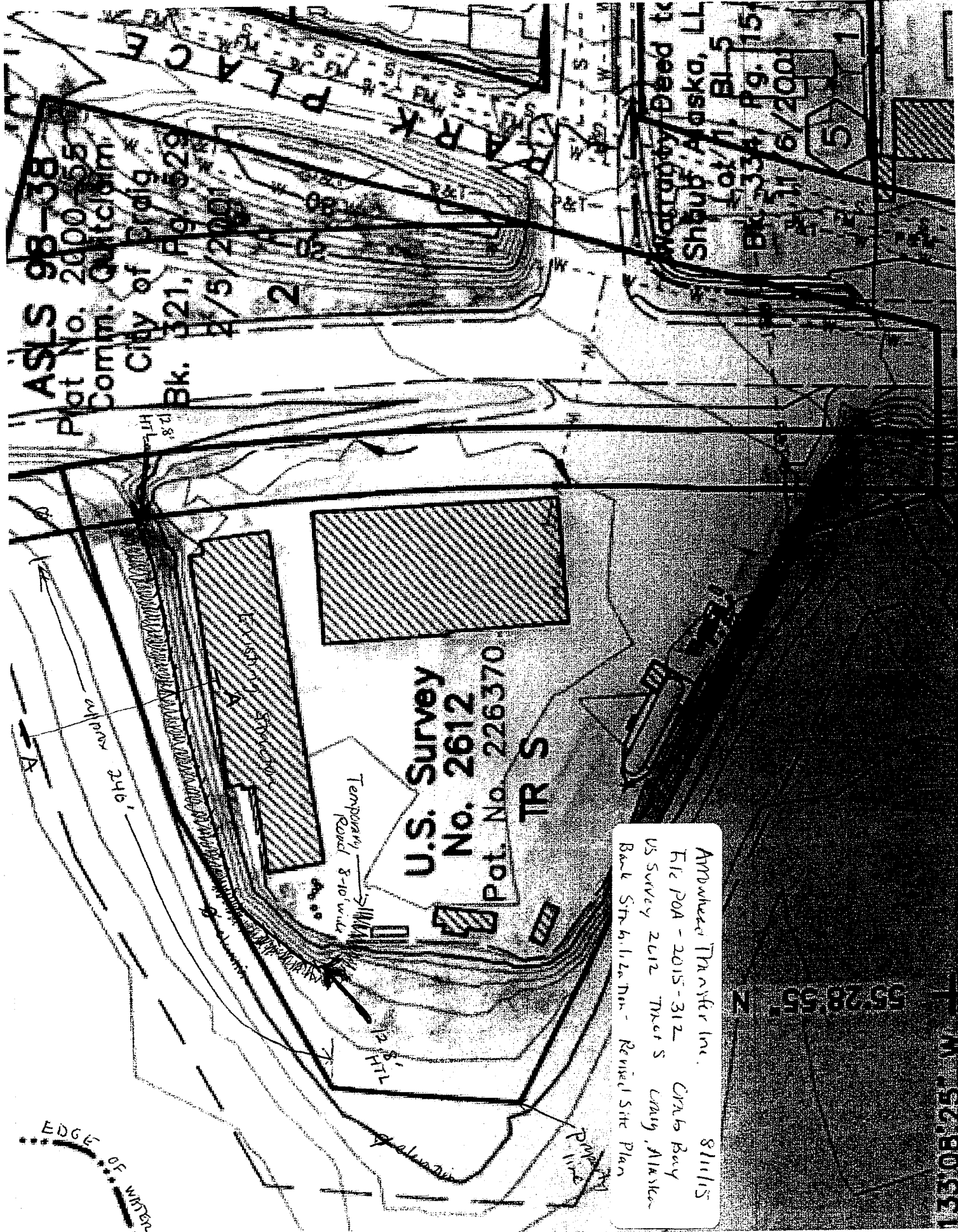

U.S. Survey
No. 2612
 Pat. No. 226370
TR S

Arrowhead Transfer Inc.	811/15
File POA - 2015-312	Crab Bay
US Survey 2612 TR S	Crab Bay, Alaska
Base Site Location - Revised Site Plan	

05 28 01
 1330B'25' W
 52' E0521

Section A - A

Arrowhead Transfer 8/11/15
 File #PCA-2015-312 CARRABAY
 US Survey 2012 tract S Craig, Alaska
 Bank Stabilization Cross Section 1 of 1

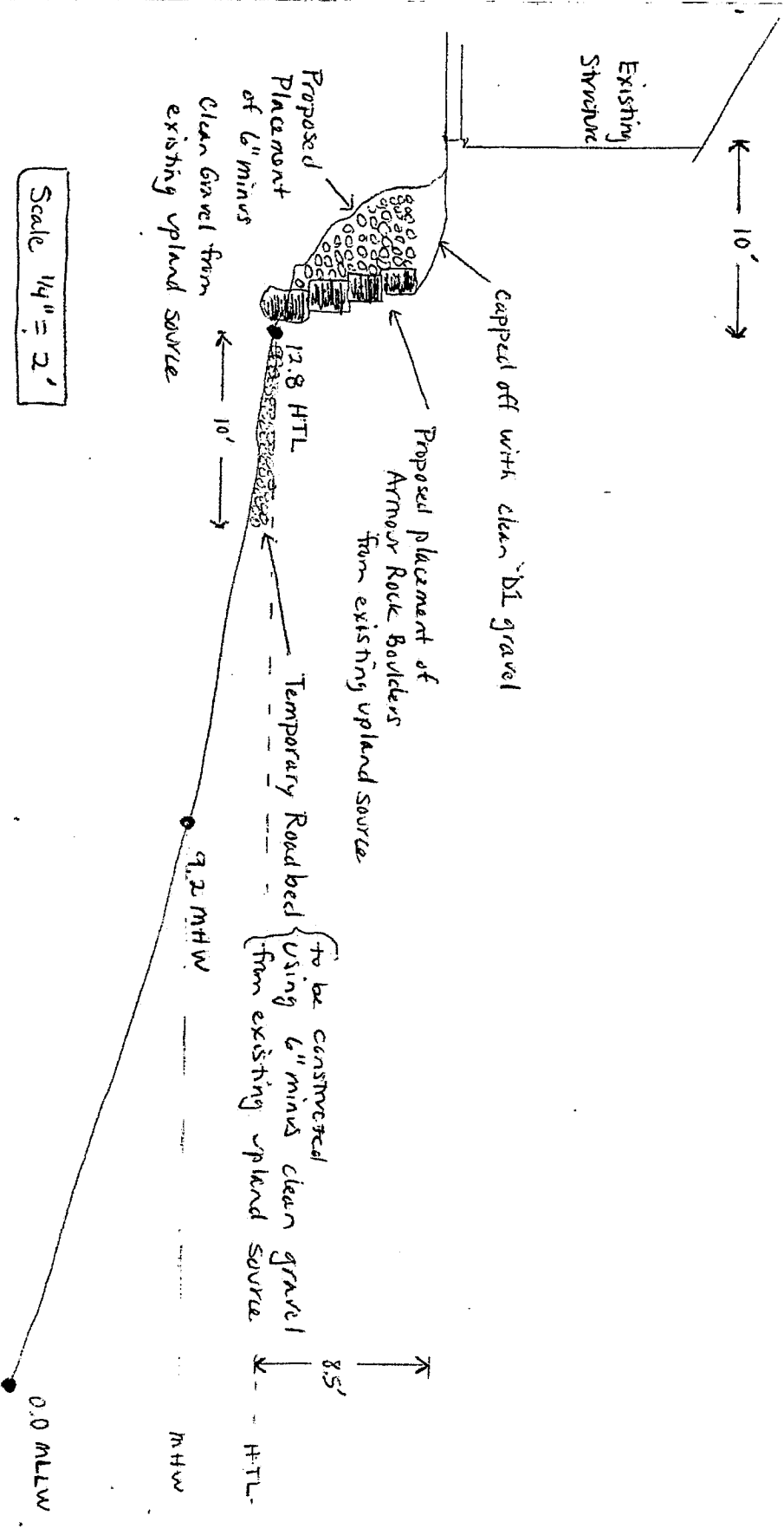

Arrowhead Transfer
File# POA-2015-312
Crab Bay Craig, Alaska

Statement Regarding Re-Vegetation 8/11/15

We have reviewed the Alaska Department of Fish & Game's Stream Bank Restoration and Protection Guidebook. It seems that the stabilization methods in the ADF&G's guidebook apply only to riparian freshwater streams. They would therefore not be applicable or useful for our proposed project which is in non-estuarine tidal waters. Therefore the ADF&G's guidebook techniques and methods were not included in the preferred alternative.

We then reviewed the Alaska Coastal Revegetation & Erosion Control Guide. As stated there, like many coastal areas of Alaska, our project area is rocky beach, with low erosion potential and dynamics. Pebbles and rocks dominate the shore zone. The terrain is stony up to the coastline, where terrestrial vegetation begins.

We have a portion of coastline bank already in existence, adjacent to the proposed project area. A majority of the existing vegetation will remain during the scope of the project. It consists of fast growing vegetation (various grasses, alder trees, salmonberry bushes, thimbleberry bushes, and devil's club) that we believe will quickly overtake the additional bank area we are establishing. Therefore we are not planning any additional re-vegetation strategies at this time.



DEPARTMENT OF THE ARMY
ALASKA DISTRICT, U.S. ARMY CORPS OF ENGINEERS
REGULATORY DIVISION
P.O. BOX 6898
JBER, AK 99506-0898

SEP 01 2015

Regulatory Division
POA-2015-312

Arrowhead Transfer, Inc.
Mr. Mike Zellhuber
Post Office 707
Craig, Alaska 99921

Dear Mr. Zellhuber:

This is in response to your May 06, 2015 Department of the Army (DA) nationwide permit (NWP) pre-construction notification (PCN) (Arrowhead Transfer, Inc.) to discharge fill material, 150 cubic yards of armour rock, 150 cubic yards of 6" minus, and 50 cubic yards of D1 gravel into estuarine and marine wetlands in order to repair and prevent further bank erosion and to protect existing structures on uplands approximately 240 feet in length. The project site is located within Section 5, T. 74 S., R. 81 E., Copper River Meridian; Latitude 55.4775° N., Longitude 133.1332° W.; in Craig, Alaska. It has been assigned file number POA-2015-312, Crab Bay which should be referred to in all future correspondence with this office.

DA permit authorization is necessary because your project may involve work in AND placement of fill material into waters of the U.S. under our regulatory jurisdiction.

As of June 20, 2015, more than 45 calendar days had passed since your complete PCN was received. In accordance with 2012 Nationwide Permit General Condition 31(a)(2), you were authorized to begin your activity under Nationwide Permit (NWP) 13, Bank Stabilization on June 20, 2015 since you did not receive written notice from the district or division engineer.

It is incumbent upon you to construct your activity in compliance with the terms and conditions of the NWP. NWP No. 13, Bank Stabilization and its associated Regional and General Conditions can be accessed at our website at www.poa.usace.army.mil/reg/Permits.htm. Regional Conditions A, B & E apply to your project.

The Nationwide Permits are due to expire on March 18, 2017, unless the NWP is modified, reissued, or revoked. It is incumbent upon you to remain informed of changes to the NWPs. Nothing in this letter excuses you from compliance with other Federal, State, or local statutes, ordinances, or regulations.

-2-

Please contact me via email at Danielle.g.shack@usace.army.mil, by mail at the address above, by phone at (907) 753-2728, or toll free from within Alaska at (800) 478-2712, if you have questions or to request paper copies of the regional and/or general conditions. For more information about the Regulatory Program, please visit our website at <http://www.poa.usace.army.mil/Missions/Regulatory.aspx>.

Sincerely,

A handwritten signature in black ink that reads "Danielle Shack". The signature is written in a cursive, flowing style.

Danielle Shack
Regulatory Specialist