

CITY OF CRAIG, ALASKA BUILDING PERMIT APPLICATION

Applicant Information

Name Patrick Murphy
 Mailing Address PO Box 595
 Street Address 601 B Beach Rd
 City, State, Zip Craig AK 99921
 Telephone (512) 785-5990

Owner Information (if not also applicant)

Name Jim Stucky
 Mailing Address PO Box 144
 Street Address _____
 City, State, Zip Craig AK 99921
 Telephone _____

Property Description

Subdivision Name _____
 Survey Number: VSS 1430 Tract Number: _____ Lot Number: 7 Block Number: 1A
 Army Corps of Engineers Permit Name and/or Number: _____

Building Activity Information (please check one)

- Single Family Home Duplex Triplex Fourplex or greater
- Deck Porch Retaining Wall Addition
- Commercial Building Wannigan Garage Shed

Mobile Home (Year and Make) 1978 Alaskan Four Seasons
 Travel Trailer (Year and Make) _____
 Other (Please describe): _____

Height of Building at Roof Eve: _____ Closest setback to ^{interior structure} property line: 13ft.

Building Dimensions: 8 x 16 Area of building footprint: 128 sq ft

What use(s) do you propose for the building? Extend roofline for wood shed, no walls.

Site Plan See Attached.

Please complete on reverse side or attached sheet a site plan showing all proposed construction.

Owner's/Applicant's Statement

I acknowledge that I have read this application and state that the above information is correct. I agree to comply with all codes and ordinances of the City of Craig applicable to building and construction, and all land use regulations as pertaining to this permit. Any violation of land management regulations are the responsibility of the property owner. This permit becomes void upon completion of the approved work, or one year, whichever comes first. Work not documented in this application is not authorized by this building permit. I understand that this permit is revocable if work is not completed consistent with this applicant or if work does not comply with the requirements of the City of Craig Municipal Code. I agree to provide the City of Craig with an as-built survey of the lot in the event one is completed for this project.

Patrick K Murphy 4-12-13
 Signature of Applicant Date

[Signature] 4/12/13
 Signature of Property Owner (if other than applicant) Date

Special Conditions of Approval.

The following conditions of approval are made a part of this permit as provided by section 18.06.001B.6 of the Craig Land Development Code:

#1. No walls within 6' of adjacent structure or 10' of property lines.

Permission is hereby granted to perform the above work in compliance with any and all conditions listed above and in compliance with the Craig Land Development Code and all other ordinances of the City of Craig and the State of Alaska pertaining to the construction of buildings.

[Signature] _____
 Signature of City Building Official Date

SITE PLAN

Show the items from the checklist below in the drawing grid. The drawing must be legible and accurate.

- Lot lines and dimensions
- Distances from all structures to lot lines
- Proposed structures with dimensions
- All easements, streets, alleys, sidewalks
- Existing structures and their dimensions
- Parking spaces

- Water lines
- Sewer lines
- Electric lines and poles
- Driveways
- North Arrow
- Other pertinent information

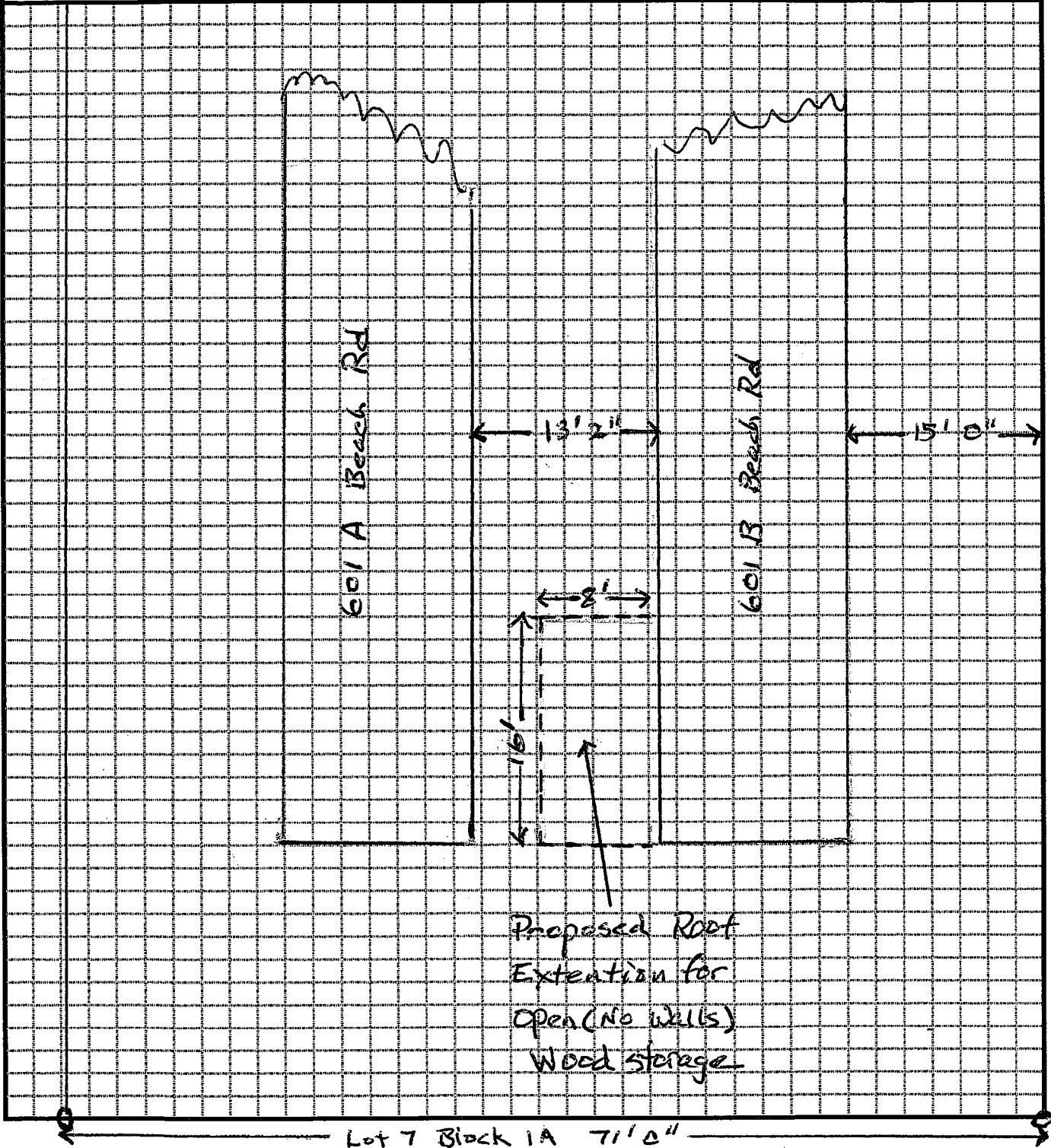

BEACH ROAD