

09-10

RECEIVED

MAY 18 2010

CITY OF CRAIG
CRAIG, ALASKA

CITY OF CRAIG, ALASKA BUILDING PERMIT APPLICATION

Applicant Information		Owner Information (if not also applicant)	
Name	<i>Lynn A. Jones</i>	Name	
Mailing Address	<i>P.O. Box 650</i>	Mailing Address	
Street Address	<i>1310 Hamilton Drive</i>	Street Address	
City, State, Zip	<i>Craig, AK 99921</i>	City, State, Zip	
Telephone	<i>826-3290</i>	Telephone	

Property Description

Subdivision Name *HS 457*

Survey Number: *USS 2611* Tract Number: Lot Number: Block Number:

Army Corps of Engineers Permit Name and/or Number:

Building Activity Information (please check one)

<input type="checkbox"/> Single Family Home	<input type="checkbox"/> Duplex	<input type="checkbox"/> Triplex	<input type="checkbox"/> Fourplex or greater
<input type="checkbox"/> Deck	<input type="checkbox"/> Porch	<input type="checkbox"/> Retaining Wall	<input type="checkbox"/> Addition
<input type="checkbox"/> Commercial Building	<input type="checkbox"/> Wannigan	<input type="checkbox"/> Garage	<input type="checkbox"/> Shed
<input type="checkbox"/> Mobile Home (Year and Make)			
<input type="checkbox"/> Travel Trailer (Year and Make)			
<input checked="" type="checkbox"/> Other (Please describe): <i>Covered Parking/Storage Area (Roof Only - No Walls)</i>			

Height of Building at Roof Eve: *7 1/2'* Closest setback to property line: *30 Ft*

Building Dimensions: *18' x 22'* Area of building footprint: *396 Ft²*

What use(s) do you propose for the building? *Vehicle & Equipment Parking & Storage*

Site Plan

Please complete on reverse side or attached sheet a site plan showing all proposed construction.

Owner's/Applicant's Statement

I acknowledge that I have read this application and state that the above information is correct. I agree to comply with all codes and ordinances of the City of Craig applicable to building and construction, and all land use regulations as pertaining to this permit. Any violation of land management regulations are the responsibility of the property owner. This permit becomes void upon completion of the approved work, or one year, whichever comes first. Work not documented in this application is not authorized by this building permit. I understand that this permit is revocable if work is not completed consistent with this applicant or if work does not comply with the requirements of the City of Craig Municipal Code. I agree to provide the City of Craig with an as-built survey of the lot in the event one is completed for this project.

Lynn A. Jones *5/18/10* *Lynn A. Jones* *5/18/10*

Signature of Applicant Date Signature of Property Owner (if other than applicant) Date

Special Conditions of Approval.

The following conditions of approval are made a part of this permit as provided by section 18.06.001B.6 of the Craig Land Development Code:

Permission is hereby granted to perform the above work in compliance with any and all conditions listed above and in compliance with the Craig Land Development Code and all other ordinances of the City of Craig and the State of Alaska pertaining to the construction of buildings.

[Signature] *5-19-10*

Signature of City Building Official Date

BP. 09-10

433.62' R.)
W 431.94'

313.16'

Approximate 30' Setback

Covered Parking Storage Area

2.14 ACRES

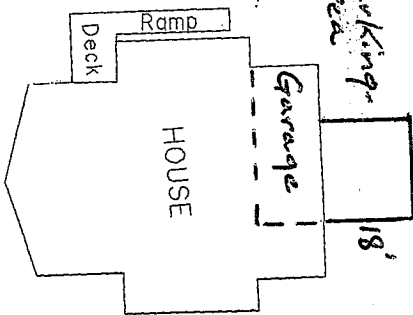

86.74'

(S 88°26' W 273.90' R.)
S88°28'57" W 272.74'

Proposed Property Line Does Not Exist At This Time.

186.00'

0.74 ACRES

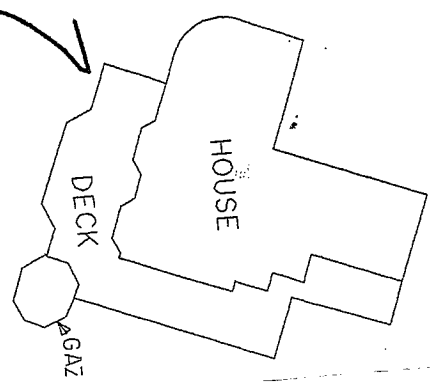

N04°42'20" W 193.36'

4

5

104.00'

PRE

HOUSES

298.54'

N78°37'00" E 474.54' (R.)

HAMILTON DRIVE

33'

W 166.87'

33.00'