

15-10

CITY OF CRAIG, ALASKA BUILDING PERMIT APPLICATION

Applicant Information

Name: *Jack Beckman*
Mailing Address: *PO Box 504*
Street Address: *506 Thomas Ct.*
City, State, Zip: *Craig, AK 99921*
Telephone: *907-826-3167*

Owner Information (if not also applicant)

Name:
Mailing Address:
Street Address:
City, State, Zip:
Telephone:

Property Description

Subdivision Name: *Street of Dreams*

Survey Number: Tract Number: Lot Number: *10* Block Number:

Army Corps of Engineers Permit Name and/or Number:

Building Activity Information (please check one)

- Single Family Home
- Deck
- Commercial Building
- Mobile Home (Year and Make)
- Travel Trailer (Year and Make)
- Other (Please describe): *Carport*
- Duplex
- Porch
- Wannigan
- Triplex
- Retaining Wall
- Garage
- Fourplex or greater
- Addition
- Shed

Height of Building at Roof Eve: *10'*

Closest setback to property line: *10'*

Building Dimensions: *10' x 24'*

Area of building footprint: *240 sq ft*

What use(s) do you propose for the building? *woodshed, carport*

Site Plan *SEE ATTACHED*

Please complete on reverse side or attached sheet a site plan showing all proposed construction.

Owner's/Applicant's Statement

I acknowledge that I have read this application and state that the above information is correct. I agree to comply with all codes and ordinances of the City of Craig applicable to building and construction, and all land use regulations as pertaining to this permit. Any violation of land management regulations are the responsibility of the property owner. This permit becomes void upon completion of the approved work, or one year, whichever comes first. Work not documented in this application is not authorized by this building permit.

I understand that this permit is revocable if work is not completed consistent with this applicant or if work does not comply with the requirements of the City of Craig Municipal Code.

I agree to provide the City of Craig with an as-built survey of the lot in the event one is completed for this project.

Rhonda L. Beckman 7-30-10

Signature of Applicant Date

Signature of Property Owner (if other than applicant) Date

Special Conditions of Approval.

The following conditions of approval are made a part of this permit as provided by section 18.06.001B.6 of the Craig Land Development Code:

#1. No WALL WITHIN 10' OF ANY PROPERTY LINE. PERMIT IS VALID FOR AN OPEN CARPORT.

Permission is hereby granted to perform the above work in compliance with any and all conditions listed above and in compliance with the Craig Land Development Code and all other ordinances of the City of Craig and the State of Alaska pertaining to the construction of buildings.

Signature of Building Official *[Signature]*

Date *7/30/10*

BP 15-10

THOMAS COURT

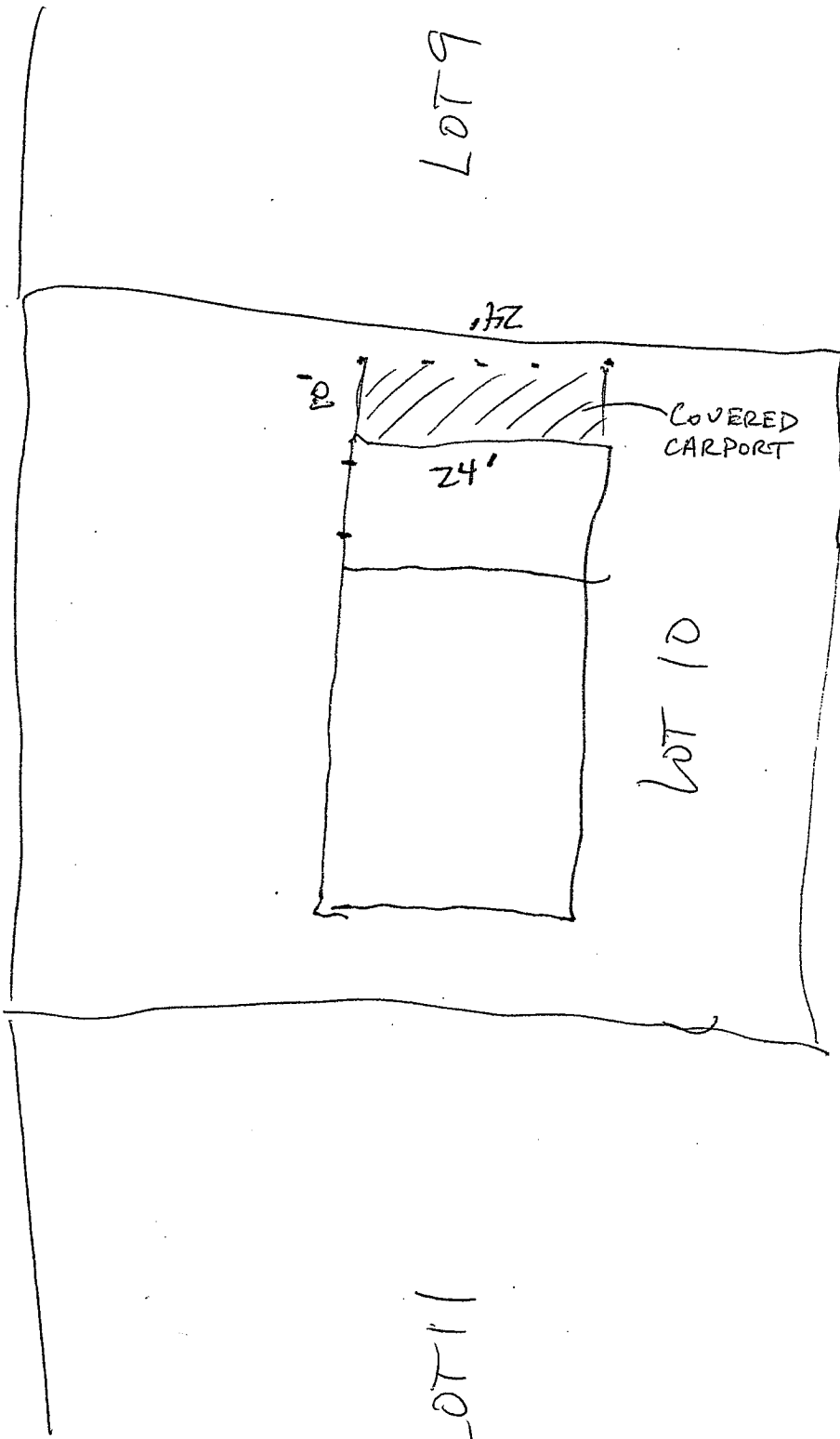

LOT 11

LOT 9

LOT 10

24'

24'

24' AZ

COVERED CARPORT