

30-08(R)

CITY OF CRAIG, ALASKA BUILDING PERMIT APPLICATION

Applicant Information		Owner Information (if not also applicant)	
Name	PRINCE OF WALES PROPERTIES, LLC	Name	
Mailing Address	PO Box 492	Mailing Address	
Street Address	333 Cold Storage Road	Street Address	
City, State, Zip	CRAIG, AK 99921	City, State, Zip	
Telephone	907-826-6255	Telephone	

Property Description

Subdivision Name: WEST WIND PLAZA SHOPPING CENTER

Survey Number: USS 2327 Tract Number: N2 Lot Number: 2-AA Block Number:

Army Corps of Engineers Permit Name and/or Number:

Building Activity Information (please check one)

<input type="checkbox"/> Single Family Home	<input type="checkbox"/> Duplex	<input type="checkbox"/> Triplex	<input type="checkbox"/> Fourplex or greater
<input type="checkbox"/> Deck	<input type="checkbox"/> Porch	<input type="checkbox"/> Retaining Wall	<input type="checkbox"/> Addition
<input checked="" type="checkbox"/> Commercial Building	<input type="checkbox"/> Wannigan	<input type="checkbox"/> Garage	<input type="checkbox"/> Shed
<input type="checkbox"/> Mobile Home (Year and Make)			
<input type="checkbox"/> Travel Trailer (Year and Make)			
<input checked="" type="checkbox"/> Other (Please describe): UPDATE + INSTALLATION OF FLOOR COVERING IN SUITE 101			

Height of Building at Roof Eve: _____ Closest setback to property line: _____

Building Dimensions: _____ Area of building footprint: _____

What use(s) do you propose for the building?

Site Plan N/A

Please complete on reverse side or attached sheet a site plan showing all proposed construction.

Owner's/Applicant's Statement

I acknowledge that I have read this application and state that the above information is correct. I agree to comply with all codes and ordinances of the City of Craig applicable to building and construction, and all land use regulations as pertaining to this permit. Any violation of land management regulations are the responsibility of the property owner. This permit becomes void upon completion of the approved work, or one year, whichever comes first. Work not documented in this application is not authorized by this building permit. I understand that this permit is revocable if work is not completed consistent with this applicant or if work does not comply with the requirements of the City of Craig Municipal Code. I agree to provide the City of Craig with an as-built survey of the lot in the event one is completed for this project.

Signature of Applicant: *[Signature]* Date: 10/6/08

Signature of Property Owner (if other than applicant): _____ Date: _____

Special Conditions of Approval.

The following conditions of approval are made a part of this permit as provided by section 18.06.001B.6 of the Craig Land Development Code:

#1. Renamed 12/15/09 RS

Permission is hereby granted to perform the above work in compliance with any and all conditions listed above and in compliance with the Craig Land Development Code and all other ordinances of the City of Craig and the State of Alaska pertaining to the construction of buildings.

Signature of City Building Official: *[Signature]* Date: 10-06-08

30-08(R)



TRACT M - LOT 3

S89°18'43"W 176.72'

Found ALCAP / Rebar

Oil Tank

Monument Found
grouted in Rock - Moved
out of position
Elec. Transformer
(on conc. pad)

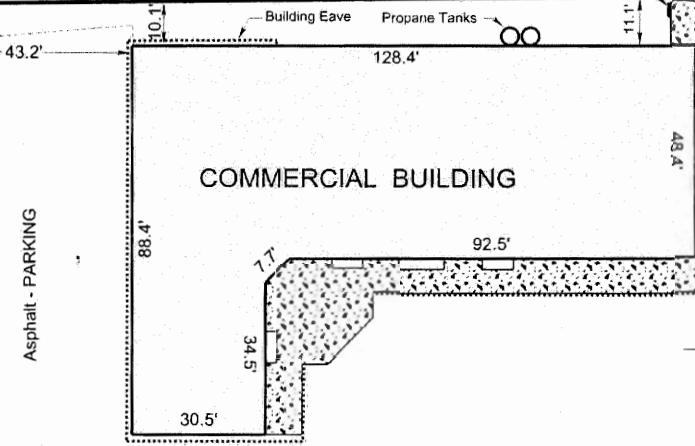

COMMERCIAL BUILDING

5.0' Prop. Line to Bldg.

Concrete Retaining Wall

Asphalt - FIRE LANE

LOT N-1-B

S0°01'19"E 329.37'

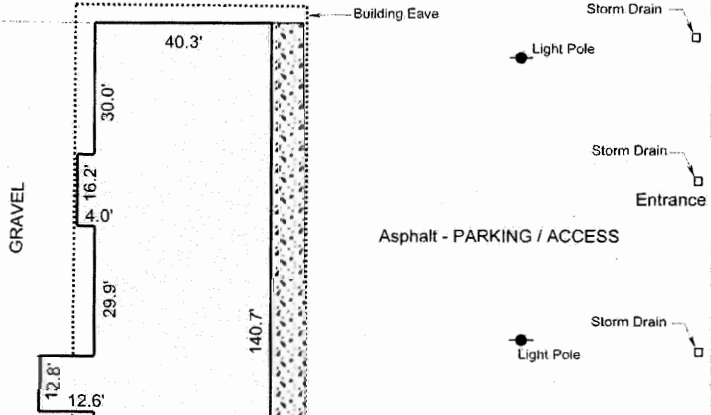

LOT 2 AA, TRACT N

covered awning addition.

COLD STORAGE ROAD

LOT N-1A

S0°01'19"E 329.37'

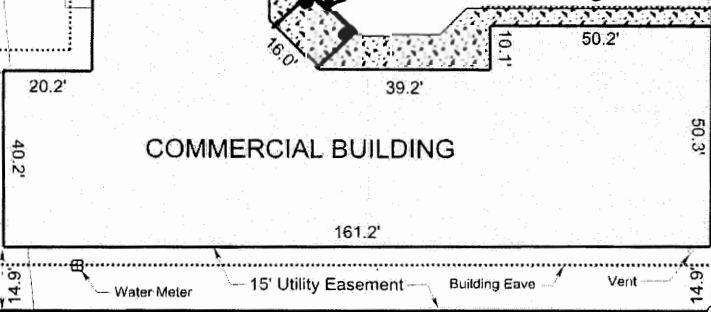

COMMERCIAL BUILDING

0.75 from Bldg. to Prop. Line

Found ALCAP / Rebar

N89°57'23"E 176.83'

Found Monument

CRAIG - KLAWOCK HIGHWAY

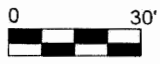

AS-BUILT SURVEY OF:
LOT 2 AA, TRACT N, USS 2327
PLAT NO. 98-31, Ketchikan recording office

I hereby certify that the above described property has been surveyed by me and that the improvements situated thereon are within the property lines and do not encroach or overlap on the adjacent property lines and that there are no roadways, transmission lines or other visible easements on said property, except as indicated hereon.

Scale: 1" = 30' Date: Oct. 24, 2005 Drawn by: Craig Templin

Templin Land Surveying
 PO Box WWP-Whale Pass
 Ketchikan, AK 99950-0280
 Ph/Fax 907-846-5120