

3d-07

CITY OF CRAIG, ALASKA
BUILDING PERMIT APPLICATION

Applicant Information

Name
Mailing Address
Street Address
City, State, Zip
Telephone

Owner Information (if not also applicant)

Name First Presbyterian Church of Craig & Klaucek
Mailing Address 300 Spruce St / 575 3rd St Box 52
Street Address
City, State, Zip CRAIG AK
Telephone 826-3282

Property Description

Subdivision Name
Survey Number: Tract Number: Lot Number: Block Number:
Army Corps of Engineers Permit Name and/or Number:

Building Activity Information (please check one)

- Single Family Home, Duplex, Triplex, Fourplex or greater, Deck, Porch, Retaining Wall, Addition, Commercial Building, Wannigan, Garage, Shed, Mobile Home, Travel Trailer

Other (Please describe): ROOFING

Height of Building at Roof Eve: Closest setback to property line:

Building Dimensions: Add 3 to 3 1/2 ft to Carport Area of building footprint: (Deck)

What use(s) do you propose for the building?

Site Plan

Please complete on reverse side or attached sheet a site plan showing all proposed construction.

Owner's/Applicant's Statement

I acknowledge that I have read this application and state that the above information is correct. I agree to comply with all codes and ordinances of the City of Craig applicable to building and construction, and all land use regulations as pertaining to this permit. Any violation of land management regulations are the responsibility of the property owner. This permit becomes void upon completion of the approved work, or one year, whichever comes first. Work not documented in this application is not authorized by this building permit. I understand that this permit is revocable if work is not completed consistent with this applicant or if work does not comply with the requirements of the City of Craig Municipal Code. I agree to provide the City of Craig with an as-built survey of the lot in the event one is completed for this project.

Signature of Applicant: Billy E. Anders Date: 11-14-07

Signature of Property Owner (if other than applicant) Date

Special Conditions of Approval.

The following conditions of approval are made a part of this permit as provided by section 18.06.001B.6 of the Craig Land Development Code:

#1. No change in bldg footprint without modification of this permit.

Permission is hereby granted to perform the above work in compliance with any and all conditions listed above and in compliance with the Craig Land Development Code and all other ordinances of the City of Craig and the State of Alaska pertaining to the construction of buildings.

Signature of City Building Official: [Signature] Date: 11-14-07

19-99 30-07

SCALE 1/8" = 1'-0"

EXISTING HOME 26' x 46'

EXISTING GARAGE 24' x 26'

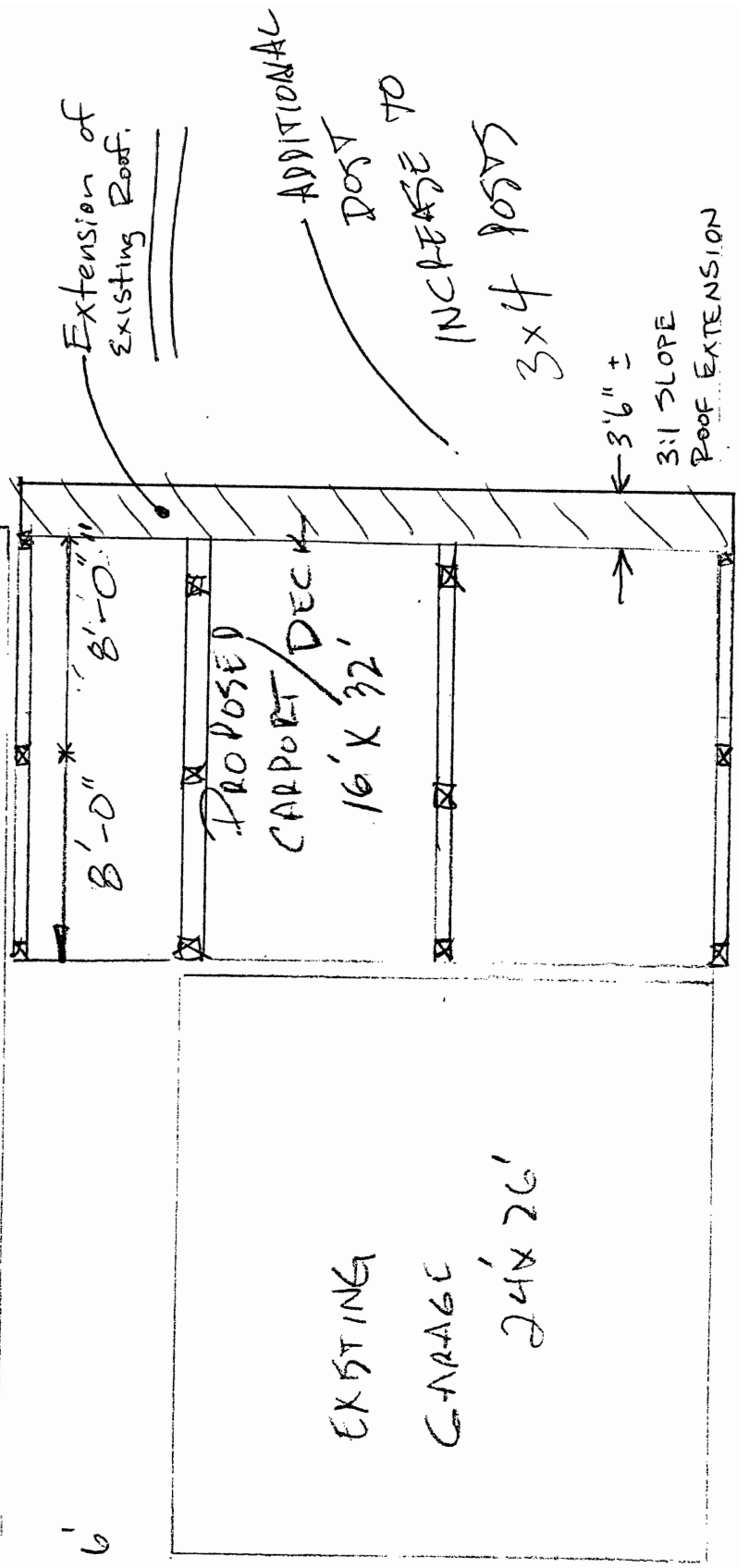

VIEW FROM WEST
SCALE 3/4" = 1'-0"

19-99

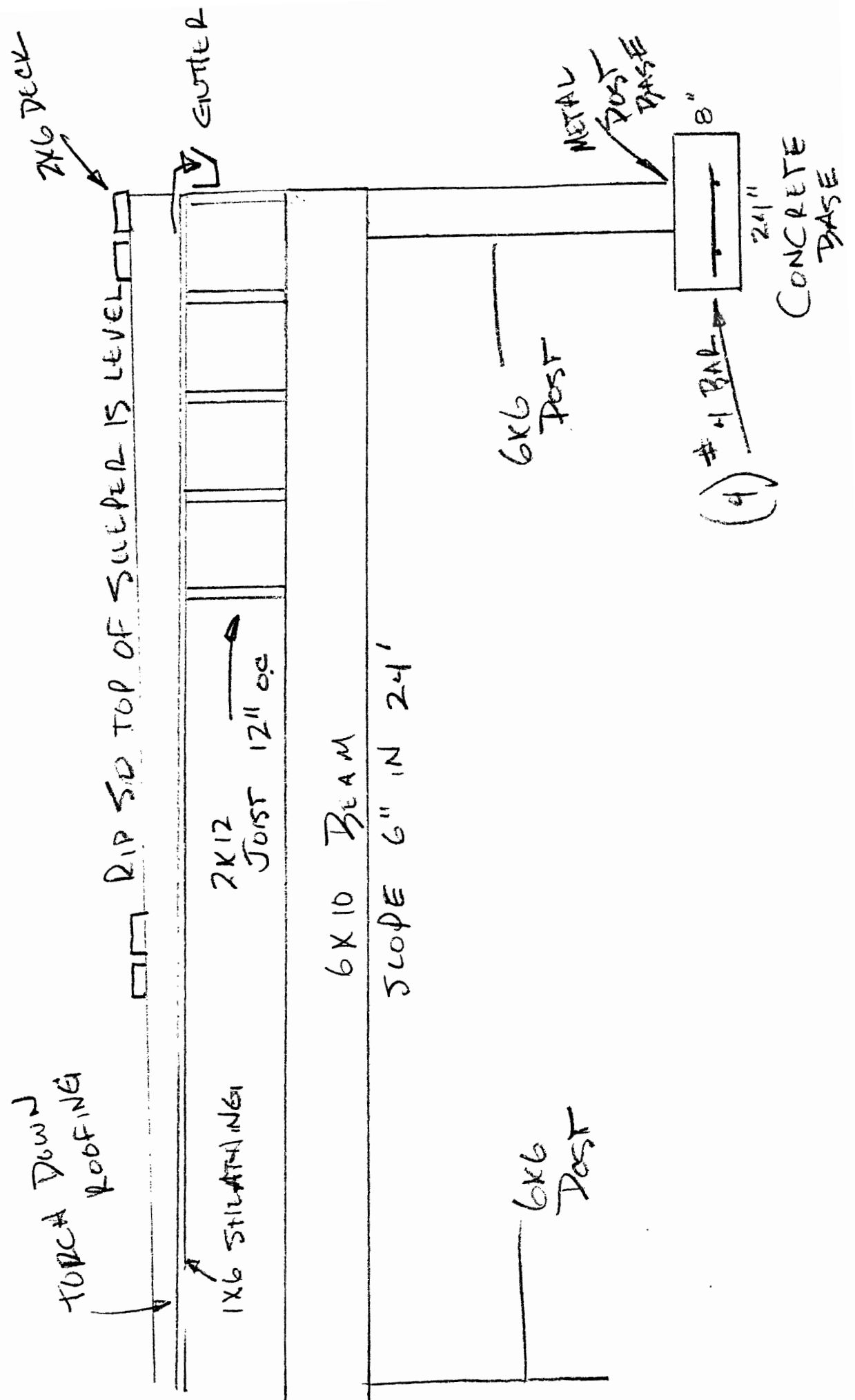

VIEW FROM
SOUTH

SCALE (1/2" = 1'-0")

19-99

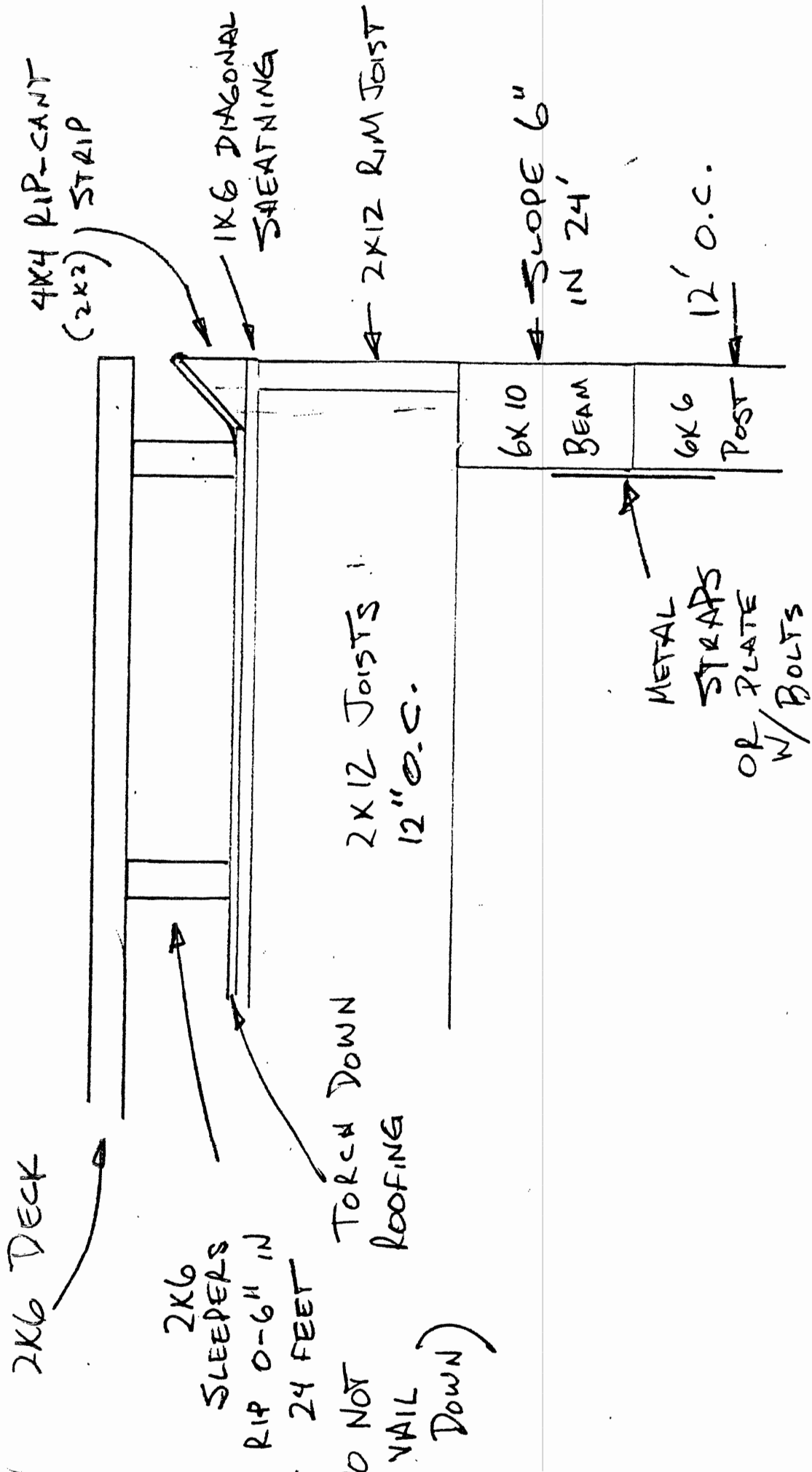

19-99

VIEW FROM
SOUTH

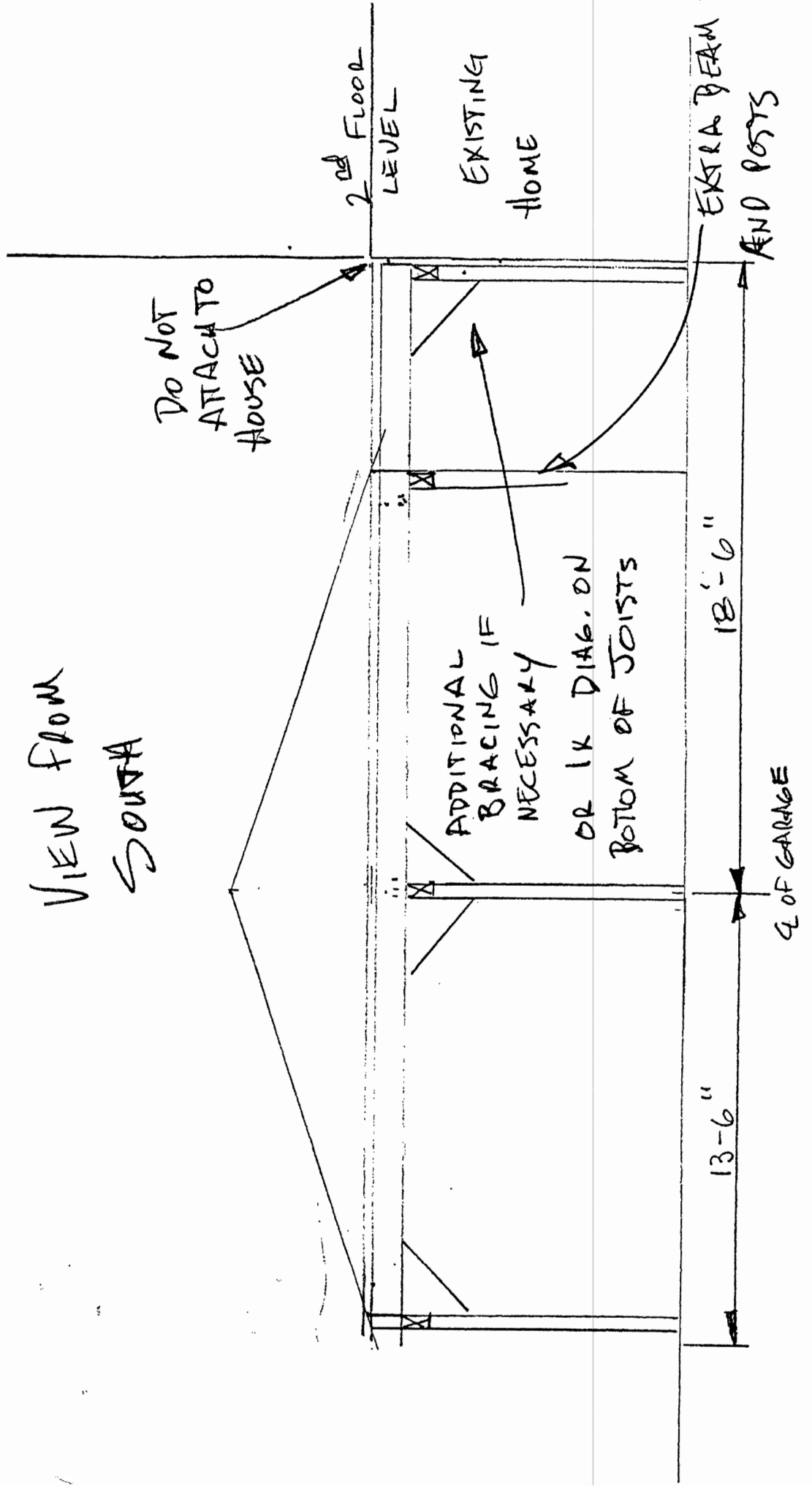

DO NOT
ATTACH TO
HOUSE

2ND FLOOR
LEVEL

EXISTING
HOME

EXTRA BEAM
AND POSTS

ADDITIONAL
BRACING IF
NECESSARY
OR 1x DIAG. ON
BOTTOM OF JOISTS

18'-6"

G. OF GARAGE

13'-6"

191-99

2x6 RAILING

2x4 STIFFENER

4x4 G' O.C.
MAX.

BEND ALUMINUM
FLASHING TO
COVER PLYWOOD

1/2"x8"
CALLAGE
BOLTS

2x2
SPACED
SO A 4" SPHERE
CANNOT PASS
BETWEEN

JOIST

3'-6"

