

**CITY OF CRAIG**

**APPLICATION FOR BUILDING PERMIT**

<b>CONTRACTOR OR APPLICANT</b>	Name <i>IS Development</i>	<b>OWNER</b>	Name <i>Jim Seley</i>
	Address <i>P.O. Box 79</i>		Address
	City <i>Craig, AK</i>		City
	Phone <i>826-3634</i>		Phone <i>209-5233</i>

<b>LEGAL DESCRIPTION</b>	Subdivision <i>17</i>			
	Survey #	Tract #	Block #	Lot # <i>17 D</i>
	Army Corps Permit #			
	Any other permits <i>N/A</i>			

New <i>2nd floor entry</i>	Mobile home
Addition <i>stairwell, deck &amp; porch</i>	Land Use
Use of Bldg* <i>Maintenance/Warehouse</i>	Fence Height
Size of Bldg <i>8x8 Porch on 17' x 22' Deck</i>	Driveway width
Height of Bldg <i>15' 3" Deck 8' high Porch</i>	Parking (off street)
Area of lot <i>Southend Shop 17 on 17D</i>	Survey (if applicable)
Repair	Move
Demolish	Other

\*Specify use of building *stairwell for 2nd floor access + fire escape*

*Doorway on exposed South facing wall requires a small 8x8 framed porch covered with Polgal translucent Sheeting also exposed stairwell areas. Only utility will be Porch lighting*

Signs	Hazard	Noise	Animals
-------	--------	-------	---------

THIS PERMIT BECOMES VOID UPON COMPLETION OF THE APPROVED WORK, OR 1 YEAR, WHICHEVER COMES FIRST. 90 DAY EXTENSIONS MAY BE APPROVED IF WRITTEN REQUEST IS RECEIVED PRIOR TO EXPIRATION OF THIS PERMIT.

WORK NOT MENTIONED IS NOT INCLUDED IN PERMIT.

I acknowledge that I have read this application and state that the above is correct. I agree to comply to all codes and ordinances of the City of Craig, applicable to building & construction and all Land Management Regulations as pertaining to this permit. Any violation of Land Management Regulations will be the sole responsibility of the property owner.

SIGNATURE OF OWNER:  
*Jim Seley*

SIGNATURE OF APPLICANT:  
*Jim Seley*

PERMISSION IS HEREBY GRANTED TO PERFORM THE ABOVE WORK ON CONDITION THAT SAME SHALL CONFORM IN ALL RESPECTS AND IN ACCORDANCE WITH THE ORDINANCES OF THE CITY OF CRAIG AND THE STATE OF ALASKA PERTAINING TO THE CONSTRUCTION OF BUILDING.

SIGNATURE OF BUILDING OFFICIAL:  
*[Signature]*

Special conditions or variances:  
*#1. Contact St. Fire Marshall prior to start of construction*

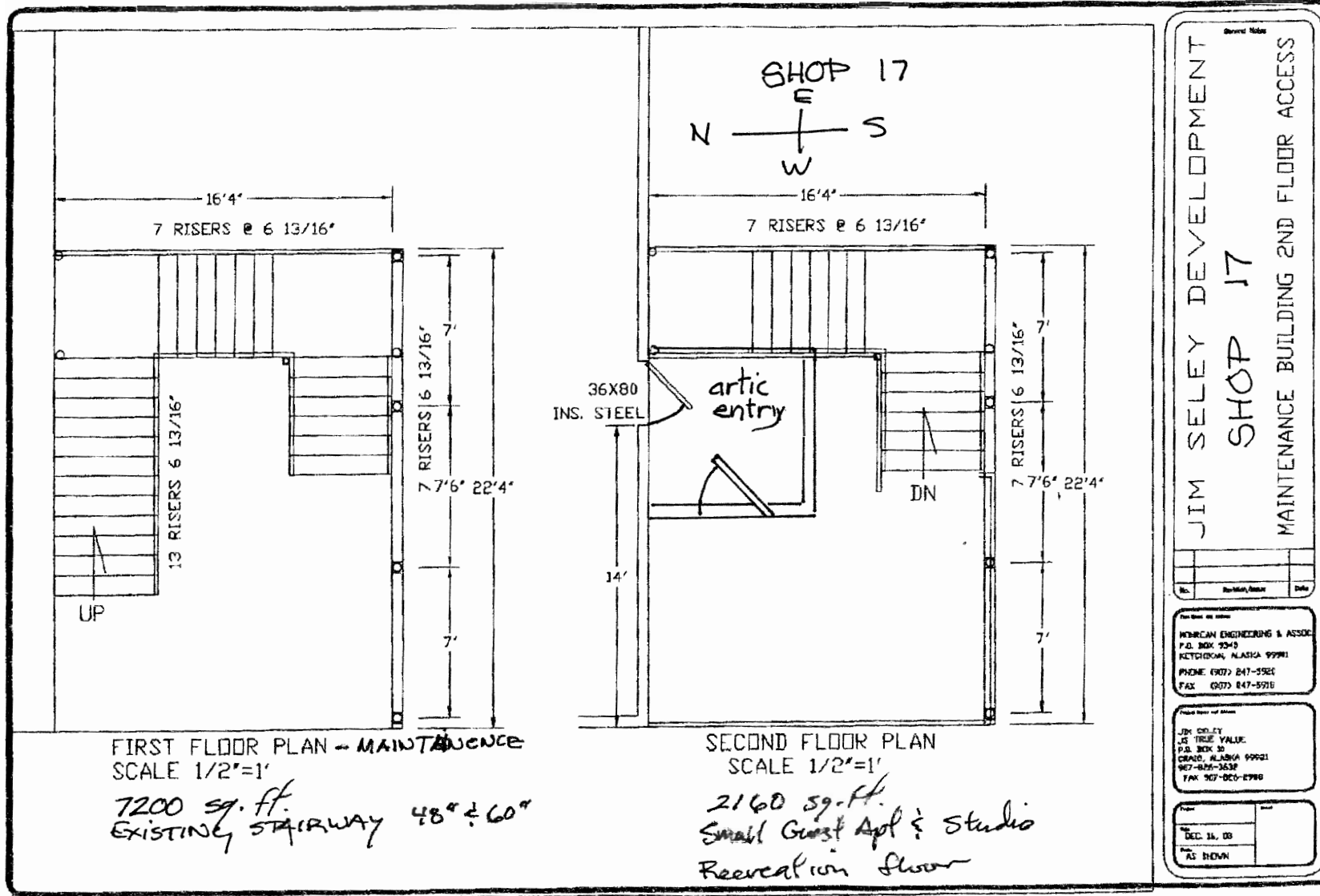

MER INC

907 2475918

P. 2